

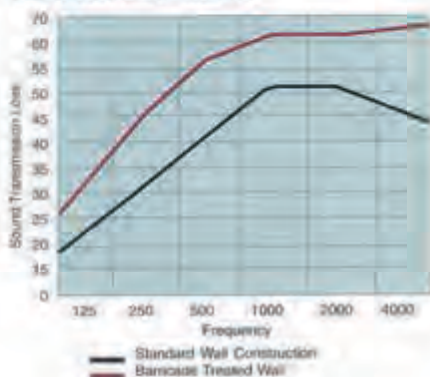

- ⦿ Hotel/Motels
- ⦿ New Construction
- ⦿ Home Theaters
- ⦿ Music Studios
- ⦿ Homes, Apartments & Condos
- ⦿ Strip Plaza
- ⦿ Residential Homes
- ⦿ Commerical Stores
- ⦿ Offices

ACOUSTICAL DATA



block transmission of sound through walls, floors, and ceilings.

All Noise Control vinyl-sound Barrier is a specially developed mass layer product offering superior acoustic transmission loss combined with good damping properties.

All Noise Control's mass/damper sheet offers STC Ratings up to 32. It is a low cost material used for a variety of marine and land based applications. The drawing below shows Vinyl-Sound Barrier installed as a suspended barrier. This typical application would improve transmission loss between adjoining spaces.

The combination of the damping and stiffness properties of Vinyl-Sound Barrier gives it excellent performance as a combined mass layer and damper when applied to partition panels and lightweight structural bulkheads, reducing transmission of both airborne and structure borne noise. Application direct to panels is best done with pre-applied pressure sensitive adhesive (PSA), backed up by minimal fasteners or staples.

Vinyl-Sound Barrier exhibits the strength and workability of conventional reinforced barrier materials, With out using a fabric layer. This innovation of intregral strength and tear resistance provides a barrier that is suitable for suspension with mechanical fasteners, without the cost normally associated with a fabric reinforced laminated product.

The standard color of Vinyl-Sound Barrier is black, Grey or Mylar facing can be applied to Vinyl-Sound Barrier for further reinforcement. Vinyl-Sound Barrier is sold by the square Foot on 4.5' wide rolls up to 500 linear feet.

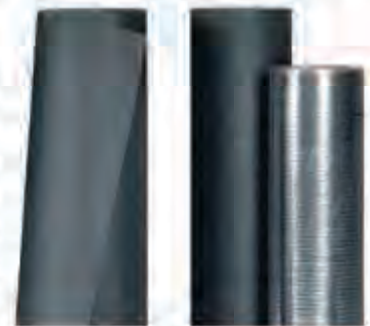

Vinyl Sound Barrier Specifications



Barrier Sheet

The Material	Surface Density	Thickness
All Noise Control Vinyl-Sound Barrier	0.5 lb/sf (2.44 kg/m ²)	1/16" (1.59mm)
Is produced on 54" (1.37m) wide rolls.	1.0 lb/sf (4.88 kg/m ²)	1/8" (3.18mm)
Length of roll varies by product density.	1.5 lb/sf (7.32 kg/m ²)	3/16" (4.76mm)
The following densities are available	2.0 lb/sf (9.76 kg/m ²)	1/4" (6.35mm)
In quantity or on a per square foot basis.		

Typical Physical Properties

Thickness (in)	1/16 to 1/4
Weights 1 lb/ft ²	.50 to 2.0
Flammability, UL 94 HF 1 <u>MVSS 302</u>	MEETS
Specific Gravity (Barrier) <u>ASTM D 798</u>	1.80
Hardness (Barrier) Shore A 2 <u>ASTM D 2240</u>	90 Nominal

Stiffness, MPA (Barrier) <u>ASTM 749</u>	19.60
Tensile, PSI (Barrier) <u>ADSTM D 412</u>	762
Elongation, % (Barrier) <u>ASTM D 412</u>	200
Tear, lbs/1" (Barrier) <u>ASTM D 624</u>	77
Temp Range, Degrees Fahrenheit	40 to 255

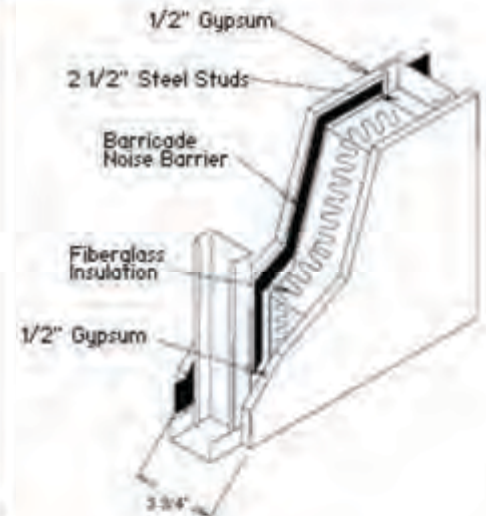

Typical Acoustic Properties

Frequency, Hz	100	125	160	200	250	315	400	500	630	800	1000	1250	1600	2000	2500	3150	4000	5000	STC
2 lb/ft, sq	18	19	18	19	19	23	26	27	28	32	34	35	37	38	40	42	43	43	32
1 lb/ft, sq	13	14	13	14	17	18	22	23	24	27	29	29	33	34	35	36	40	40	27
.5 lb/ft, sq	8	5	6	7	12	13	14	15	17	19	22	22	24	26	28	30	32	32	20



2731 Vista Parkway D-6
West Palm Beach, FL 33411
(561) 964-9360
info@allnoisecontrol.com